

# 2024

## ACADEMIC SHOWCASE

# SCHEDULE

**Tuesday, April 16**  
**9 a.m. - 4 p.m.**



[www.franklinpierce.edu/academicshowcase](http://www.franklinpierce.edu/academicshowcase)

Franklin Pierce University welcomes you to the  
**2024 Academic Showcase**

---

WELCOME

**Dr. Kim Mooney '83, President**

Franklin Pierce University

9:00 a.m. | Spagnuolo Hall

SCHEDULE OF EVENTS

**Poster Session One**

9:15 - 10:30 a.m. | Spagnuolo Hall

**Student, Faculty, and Staff Presentations**

10:00 a.m. - 12:00 p.m. | Various Locations

**Brain Bowl**

12:00 - 1:00 p.m. | Marketplace Café

**Student, Faculty, and Staff Presentations**

1:00 - 3:40 p.m. | Various Locations

**Rock Band Performance**

1:10 p.m. | Cheney Hall

**Poster Session Two**

1:10 - 2:20 p.m. | Spagnuolo Hall

**Seed Planting Event**

3:30 - 4:00 p.m. | Library Café Patio

**Maple Syrup Label Competition**

9:00 a.m. - 4:00 p.m. | DiPietro Library

**Virtual Presentations**

[www.franklinperce.edu/academicshowcase](http://www.franklinperce.edu/academicshowcase)

# SPAGNUOLO HALL, EMILY FLINT CAMPUS CENTER

TIME	TITLE	PRESENTER
9:00 - 9:15 a.m.	WELCOME by Dr. Kim Mooney '83, <i>President Franklin Pierce University</i>	
9:15 - 10:30 a.m.	Poster Session One	Abigail Ainsworth '25, Jaden Bauer '26, Lauren Birney '24, Cameron Bishop '27, Briahna Bouchard '24, Jessie Bouley '24, Ariana Brew '25, Claire Casey '24, Caitrin Collins-Hazley '25, Mary Cook '25, Thomas Darrah '24, Carissa Davis '25, Maleena Davis '23, Tereasa Deasey '25, Matigan DeFeo '25, Fallon Dellavecchia-Ronan '25, Emily Emerson '24, Mattie Fitzpatrick '24, Alexis Frank '25, Shania Francois '25, Jada Fuentes '24, Christian Garcia '26, Lily Grande '26, Conall Halvey '25, Jill Hertl '26, Cailidh Houde '25, Emily Houle '24, Amy Jones '26, Zoe Kalogeropoulos '26, Brianna Kelley '24, Lauren Klein '26, Aino Martikainen '24, Connor Nordmann '24, Kaylyn Penna '24, Oran Peterson '24, Emile Prive '24, Morgan Saletnik '25, Claire Mary Stewart '24, Connor Struckman '25, Christy Vernon '26, Kacie Viel '24, Molly Weiderhold '25, and Associate Professor Jennie Brown
1:10 - 2:20 p.m.	Poster Session Two	Cooper Anderson '27, Hailey Bigelow '27, Geanna Bryant '27, Ryan Cioffi '27, Alexandra Cistolo '27, Owen Clark '27, Geovany Cohen '27, Leah Donati '27, Jack Dunham '27, Mia Giuliano '27, Raven Groblewski '27, Maggie Price '27, Tysheanna Stewart '27, Trevon Thomas '27, Katie Tustin '27, John Viens '27, Abigail Whitley '27, and Eric Winitzer '27

## FITZWATER 101, MARLIN FITZWATER CENTER FOR COMMUNICATION

TIME	TITLE	PRESENTER	FORMAT
10:00 - 10:30 a.m.	A Lens on Neurodiversity in the Collegiate Community	Assistant Professor Leslie Buddington, Professor Joan Swanson and Anna Erikson '25	Presentation
11:20 - 11:50 a.m.	The Camino as Classroom: Walking to Santiago as Our Semester Abroad	Ian Morrell '25 Gavin Bently '25 Mackenzi Drouin '25 Ashley Femino '25 Amiah Johnson '25 Camden Jordan '24 Jonathan Lawrence '26 Courtney Leonard '26 Dominic Montoya '26	Presentation
12:00 p.m. - 12:30 p.m.	Training Law Enforcement to Respond Effectively to Mental Health Calls	Jonna Souza '25	Presentation

## FITZWATER 103, MARLIN FITZWATER CENTER FOR COMMUNICATION

TIME	TITLE	PRESENTER	FORMAT
10:00 - 10:30 a.m.	Transitions in John Prine's "Souvenirs"	Professor Paul Jenkins, University Librarian	Presentation
10:40 - 11:10 a.m.	Bar Passage Rates and Attributing Passages Can India Effectively Harness its Soaring Population and become a True Superpower?	Michael Cote '24 Sean Trumper '24	Presentation
11:20 - 11:50 a.m.	The Impact of Digital Disinformation on Immigration Discourse in Europe: A Comparative Analysis of Spain and England Governmental Transparency	Gabriela Sanchez-Parodi Reveron '24 Matthew Keyes Johnson '24	Presentation

## FITZWATER 103,

### MARLIN FITZWATER CENTER FOR COMMUNICATION

TIME	TITLE	PRESENTER	FORMAT
1:10 - 1:40 p.m.	"It's the Economy Stupid" Public Economic Perceptions and Presidential Approval Rating	Abigail Farley '24	Presentation

## FITZWATER STUDIO,

### MARLIN FITZWATER CENTER FOR COMMUNICATION

TIME	TITLE	PRESENTER	FORMAT
11:20 - 11:50 a.m.	Voices on the Road to the White House	Abigail Farley '24	Presentation
1:10 - 1:40 p.m.	Anatomy of a Conspiracy Theory - the "White Genocide" Myth in the US	Associate Professor Christina Cliff	Presentation

## MARCUCELLA 102, MARCUCELLA HALL

TIME	TITLE	PRESENTER	FORMAT
10:00 - 10:30 a.m.	Natural and Cultural Resource Inventory Project for the FPU Rindge Campus	Professor Catherine Koning and Connor Nordmann '24	Presentation
10:40 - 11:10 a.m.	Food Choices and Nutritional Status of Franklin Pierce Students	Briahna Brouchard '24 Patricia Egan '24	Presentation
11:20 - 11:50 a.m.	Ravens and Eagles Writing Collaboration	Professor Joan Swanson Dean Andrew Pollom and Superintendent Reuben Duncan	Presentation
1:10 - 1:40 p.m.	Biomolecular Condensates and Prostate Cancer	Forrest Veilleux '24	Presentation
1:50 - 2:20 p.m.	Malleus Maleficarum: Witch Trial Enactments in Early Modern Europe	Trinity Bridge '24 Zack Burton '24 Natalie Ferdinand '27 Lily Levesque '27 Nyanaroup Luwal '27 Logan Schluter '24 Abby Whitley '27	Presentation

# MARCUCELLA 102, MARCUCELLA HALL

TIME	
2:30 - 3:30 p.m.	<p><b>Faculty Research Lightning Round</b></p> <p>Anti-Violence begins at Home, Associate Professor Jean Dawson</p> <p>#YesAllWomen: The Massacre at Isla Vista, Professor Donna Decker</p> <p>The Struggle to See Native People in the Monadnock Region, Professor Robert Goodby</p> <p>White Lightning, Associate Professor Zan Walker Goncalves</p> <p>“Kalapuyan” Women and Gender Relations, 1800-1850, Professor Melinda Jette</p> <p>Irish Identity and Immigration, Professor Mary Kelly</p> <p>Why is R Better than SAS and Excel, Associate Professor Shallee Page</p> <p>Universities’ Sexual Misconduct Policies as a Barrier to Reporting Sexual Violence: A Comparative Analysis, Assistant Professor Johnna Pike</p> <p>Who Cares About Conodonts? I Do!, Professor Fred Rogers</p> <p>Virtual Reality, Assistant Professor Lindsay Vago</p>

# PETROCELLI HALL 224 PRINT LAB, PETROCELLI HALL







TIME	TITLE	PRESENTER	FORMAT
10:00 - 11:10 a.m.	Intaglio Printing Using Recycled PETG Plastic	Prudence Bosire '27 Emma Butler '27 Maura Joseph '24 Jenna Parent '24 Susan Silverman, Associate Professor of Fine Arts	Video Demonstration 

# PETROCELLI HALL 114, PETROCELLI HALL

TIME	TITLE	PRESENTER	FORMAT
10:00 - 10:30 a.m.	#POWEROFMEMORY	Karoline Hartner '26 Addison Swasey '26 Noah Garofalo '24 and Simeon Mills '25	Presentation
10:40 - 11:10 a.m.	Victims of Family Filicide in the United States: The Case of Caylee Anthony  Are Child Abduction Policies Universally Beneficial investigating and Solving Highly Publicized Cases like Madeleine McCann?	Madelyn Frye '24  Jolie Rodriguez '24	Presentation
11:20 - 11:50 a.m.	Consequent Reality of Sexual Assault Survivors  The Official Guide to Policing Anytown	Caitlin Stearns '24  Amy Jones '26	Presentation
1:10 - 1:40 p.m.	Gun-Related Death Rates in Each of the United States and their Correlation to the Household Gun Ownership Percentage  Health Insurance Correlation to Juvenile Crime	Jalilyah Gonzalez '26  Brooke Blackburn '26 Katholiki Koukia '26	Presentation

## OTHER LOCATIONS

TIME	PRESENTATION	LOCATION
12:00 - 1:00 p.m.	Brain Bowl: Marketplace Café	
1:10 - 1:40 p.m.	Music Club Concert Tyler Blain '24, Andrew Knopf '27, Logan Pratt '24, Diego Alvarez '26, and Aidan Landry '26	Cheney Hall
3:30 - 4:00 p.m.	Seed Planting Event	Library Café Patio

 Roadways / Parking Lots	<b>Map Key</b>	 One Way Roads
 Student Walkways		 Two Way Roads
 Faculty/Staff Parking	 Student Parking	 Visitor Parking

\*CAUTION Campus roadways are One Way

## 2024 Academic Showcase

★ Locations

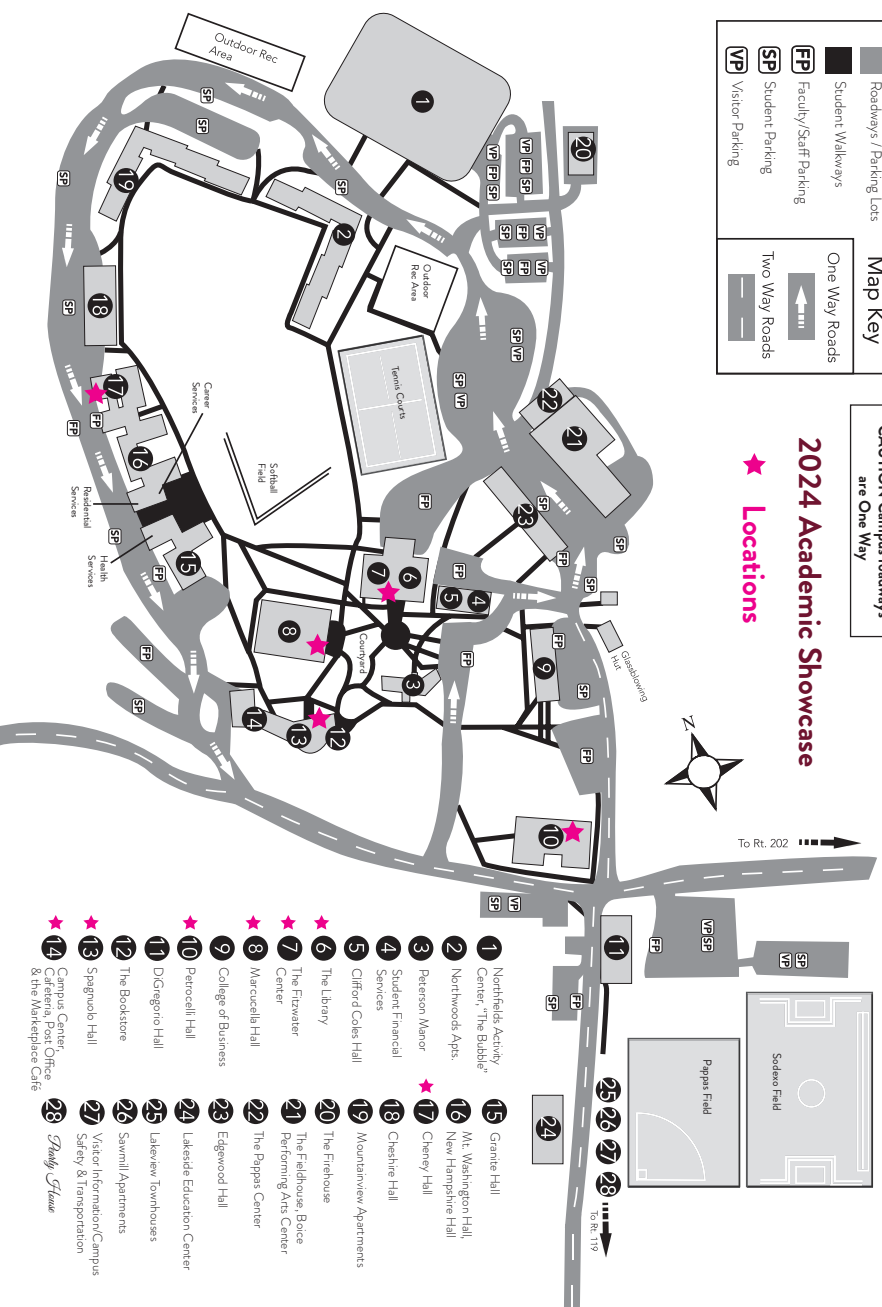

- ★ 1 Northfield Activity Center, "The Bubble"
- ★ 2 Northwoods Apts.
- ★ 3 Peterson Manor
- ★ 4 Student Financial Services
- ★ 5 Clifford Coles Hall
- ★ 6 The Library
- ★ 7 The Freshwater Center
- ★ 8 Marcellus Hall
- ★ 9 College of Business
- ★ 10 Petrelli Hall
- ★ 11 DiGregorio Hall
- ★ 12 The Bookstore
- ★ 13 Spignuolo Hall
- ★ 14 Campus Center, Cafeteria, Post Office & the Marketplace Cafe
- 15 Granite Hall
- 16 Mt. Washington Hall, New Hampshire Hall
- ★ 17 Cheney Hall
- 18 Chesire Hall
- 19 Mountainview Apartments
- 20 The Firehouse
- ★ 21 The Fairhouse, Bice Performing Arts Center
- ★ 22 The Pappas Center
- ★ 23 Edgewood Hall
- ★ 24 Lakeside Education Center
- ★ 25 Lakeview Townhouses
- ★ 26 Sawmill Apartments
- ★ 27 Visitor Information/Campus Safety & Transportation
- ★ 28 *Study Tables*