



IMAGINE  
*Nation*

Tuesday, April 15 | 9 a.m. - 4 p.m.

2025

ACADEMIC SHOWCASE

SCHEDULE

[www.franklinpierce.edu/academicshowcase](http://www.franklinpierce.edu/academicshowcase)



IMAGINE  
*Nation*

Franklin Pierce University welcomes you to the  
**2025 Academic Showcase**

---

**WELCOME**

**Dr. Peter Eden, President**

Franklin Pierce University

9:00 a.m. | Spagnuolo Hall

**SCHEDULE OF EVENTS**

**Poster Session One**

9:15 a.m. - 10:30 a.m. | Spagnuolo Hall

**Student, Faculty, and Staff Presentations**

10:00 a.m. - 11:50 a.m. | Various Locations

**Brain Bowl**

12:00 p.m. - 1:00 p.m. | Dining Hall

**Student, Faculty, and Staff Presentations**

1:00 p.m. - 4:00p.m. | Various Locations

**Poster Session Two**

1:00 p.m. - 2:00 p.m. | Spagnuolo Hall

**Maple Syrup Label Competition**

9:00 a.m. - 4:00 p.m. | DiPietro Library

MORNING SESSIONS

TIME	LOCA-TION	PRESENTER	TITLE
9 - 9:15am	Spagnuolo Hall		Opening Remarks
9-10:30am	Spagnuolo Hall	Baneen Al Ghadhbawi '25, Ashlyn Bosse '25, Mollie Cahalane '26, McKenna Cantin '26, Mia Cocchiaro '28, Ruby Conroy '26, Jenna Delgado '26, Alexis Frank '25, Alyssa Gosselin '25, Lily Grand '26, Raven Groblewski '27, Morgan Hellman '26, Laia Llorente Iglesias '26, Brea Mathieu '26, Dominic Montoya '25, Trent O'neill '27, Martina Spackova '26, Colin Struckman '25, David Talbot '25, Emily Webster '26, Molly Wiederhold '25, Isabella Williams '25 and Professor Rudra Aryal	Morning Poster Session
10-10:30am	Fitzwater Hall 101	Professor Robert Goodby	Sites, Landscapes, and Three Decades of Archaeology in the Monadnock Region
	Fitzwater Hall 102	Associate Professor Christina Cliff	You might be an extremist if...
	Fitzwater Hall 103	Professor Paul Jenkins	Take Me on a Trip: Bob Dylan's "Mr. Tambourine Man."
	Fitzwater Studio	Evan Coady '25, Dominic Howard '25 and Erik Valdovinos '26	Broadcasting at the NCAA Championship
	Marcucella Hall 102	Associate Professor Joan Swanson, Director of Education, Superintendent Reuben Duncan, Assistant Professor Thomas Bennett, and Laura Harding, M.Ed.	Ravens, Owls and Eagles: Building Scholars and Leaders through Collaborative Initiatives
	Petrocelli Hall 114	Assistant Professors Lara Ingram and Len Crossman	Intoxication Imagination: Alcohol versus Brain and Legal System
10am - 12pm	Marcucella Hall Patio	BI 302 Food Systems Students, College of Health and Natural Sciences Faculty Advisor, Dr. Nan Fey-Yensan	Imagine a Food Secure Nation
	In Front of DiPietro Library	The Counseling Center, Division of Student Affairs, The Office of Diversity and Inclusion, and The College of Health and Natural Sciences	Rations for Ravens <i>Student Food Pantry Project</i>

TIME	LOCATION	PRESENTER	TITLE
	<i>DiPietro Library Courtyard</i>	EN 203 Introduction to British Literature and EN 313 Shakespeare Classes	Poetry on Demand
	<i>RAKU KILN PAD</i>	Z Abdelnur '27, Lauryn Charron '28, Alexis DiMeo '28, Grace Rich '25, Kaylee Shaw '28, and Norah Tasini '28	Raku Firing: Alternative Ceramics
10:40-11:10am	<i>Fitzwater Hall 101</i>	Lily Grande '26  Evelyn Haley '26	Indigenous Women's Activism in the West, mid-19th Century-early 20th Century The Resistance, Adaptation, and Survival of Northern Cheyenne Women: How Northern Cheyenne Helped Navigate the Post Civil War Period
	<i>Fitzwater Hall 102</i>	Martina Spackova '26  Taylor Ellis '26	The Vrba-Wetzler Report Hamas
	<i>Fitzwater Hall 103</i>	Connor Burt '25	Global Irish Studies at FPU
	<i>Fitzwater Studio</i>	Abigail Farley '24	DNC Experience
	<i>Marcucella Hall 102</i>	Teresa Deasy '25 and Molly Wiederhold '25	Do Small Mammals Occurring in Woodlands Recognize Tree Line Depending on their Habitat Preference when Released in a Meadow?
	<i>Petrocelli Hall 114</i>	Emily Webster '26 and Assistant Professor Leslie Buddington	A Preliminary Analysis of Serial Killer, Non-offender, and Other Offender Eyes
11 a.m. - 1 p.m.	<i>Marcucella Hall Patio</i>	Institute for Climate Action	Climate Change Fun! Do you care about climate change? Come and enjoy some nature crafts and games and learn about solutions to climate change at the same time.
11:20-11:50am	<i>Fitzwater Hall 101</i>	Kori Garnhardt '26	Systemic Racism and Wrongful Convictions
	<i>Fitzwater Hall 102</i>	Megan Raymond '25  Damani Domerson '25	Creating a Functional Advertising Agency Franklin Pierce University SWOT
	<i>Fitzwater Hall 103</i>	David Evers '25	<i>Citizens United v. Federal Election Commission</i> (2010) through the Lens of Conflict Theory
	<i>Marcucella Hall 102</i>	Professor Jacques Veilleux	Fall Activity Patterns of Bats at New Hampshire Hibernacula
	<i>Petrocelli Hall 114</i>	Amy Jones '25	Federal Prosecutions: Effective Public Safety or Politics?
12-1pm	<i>Dining Hall</i>		Brain Bowl

AFTERNOON SESSIONS

TIME	LOCATION	PRESENTER	TITLE
1-2pm	Spagnuolo Hall	Elizabeth Albert, Elizabeth Anderson, Matthew Canavan, Sean Cote, Emma Duffy, Jackson Duffy, Brady Gaudet, Lauren Muldoon, Mario Paganini, Issys Price, Brianna Russo, Cally Stone, Brianna Whitelaw, and Gianna Joy Wilson	Afternoon Poster Session: Class of 2028
1-3:15pm	Cheney Hall	Andrew Knopf '27, Diego Alvarez '26, Vetchayung Khumnirdpayak '26, Kennedy Morris '27, Devin Johnson '28, Emma Pavlowich '28, Jackson Duffy '28, and Aidan Landry '26	Musical Performances
1-2pm	Marcucella Hall Patio	BI 302 Food Systems Students, College of Health and Natural Sciences Faculty Advisor, Dr. Nan Fey-Yensan	Imagine a Food Secure Nation
1-2pm	In Front of DiPietro Library	The Counseling Center, Division of Student Affairs, The Office of Diversity and Inclusion, and The College of Health and Natural Sciences	Rations for Ravens <i>Student Food Pantry Project</i>
1-2pm	DiPietro Library Courtyard	EN 203 Introduction to British Literature and EN 313 Shakespeare Classes	Poetry on Demand
1:30-2pm	Fitzwater Hall 101	Megan Raymond '25 and Damani Domerson '25	Rebranding FPU: MK304 Class Project
	Fitzwater Hall 102	Abigail Ainsworth '25  Morgan Thurber '25	Charles Manson's Behavior Explained Through Micro-Level Theories  The Devastating Effects of Kidnapping
	Fitzwater Hall 103	Mary Cook '24  Taylor Ellis '26	Comparative Growth Rates of Grass on Eco-Loam vs. Traditional Loam: A Study of Sustainable Soil Solution  Nazi Propaganda
	Marcucella Hall 102	Martina Spackova '26 and Associate Professor Frank Cohen	PO322 Campaigns, Elections, and Policy Process: Findings from our 2024 Election Survey of the Political Beliefs of the Franklin Pierce University Community

TIME	LOCATION	PRESENTER	TITLE
	<i>Petrocelli Hall 114</i>	Dillon White '25 and Alioune Diaw '25	Analyzing Aaron Hernandez' Behavior through Criminological Theories
2:10-3:25pm	<i>Marcucella Hall 102</i>	Assistant Professor Tom Bennett, Professor Catherine Koning, Associate Professor Frank Cohen, Associate Director of Diversity and Inclusion Florisbeth Joseph, Assistant Professor Liz Lapon, and Assistant Professor Johnna Pike with students	Forks in the Road: How Does our Government Create Opportunity and Prosperity for All?
	<i>Petrocelli Hall 114</i>	Haley Bigwood '25, Nick Cattabriga '25, Fallon Dellavecchia-Ronan '25, David Evers '25, Amy Jones '25, Jonathan Lawrence '26, and McKenzie Rich '26	Lessons Learned from Criminal Justice Internships: Working with Justice Involved Individuals
3:30-4pm	<i>Marcucella Hall 102</i>	Assistant Professor Elizabeth Lapon, Associate Professor Joan Swanson, Director of Education and Professor Shallee Page, Assistant Professor Leslie Buddington, and Part-Time Professor Rebecca Dragon	Faculty Lightning Round

**\*CAUTION** Campus roadways  
are One Way

## 2025 Academic Showcase

★ Locations

<ul style="list-style-type: none"> <li>Roadways / Parking Lots</li> <li>Student Walkways</li> <li>Faculty/Staff Parking</li> <li>Student Parking</li> <li>Visitor Parking</li> </ul>	<b>Map Key</b> <ul style="list-style-type: none"> <li>One Way Roads</li> <li>Two Way Roads</li> </ul>
--	---

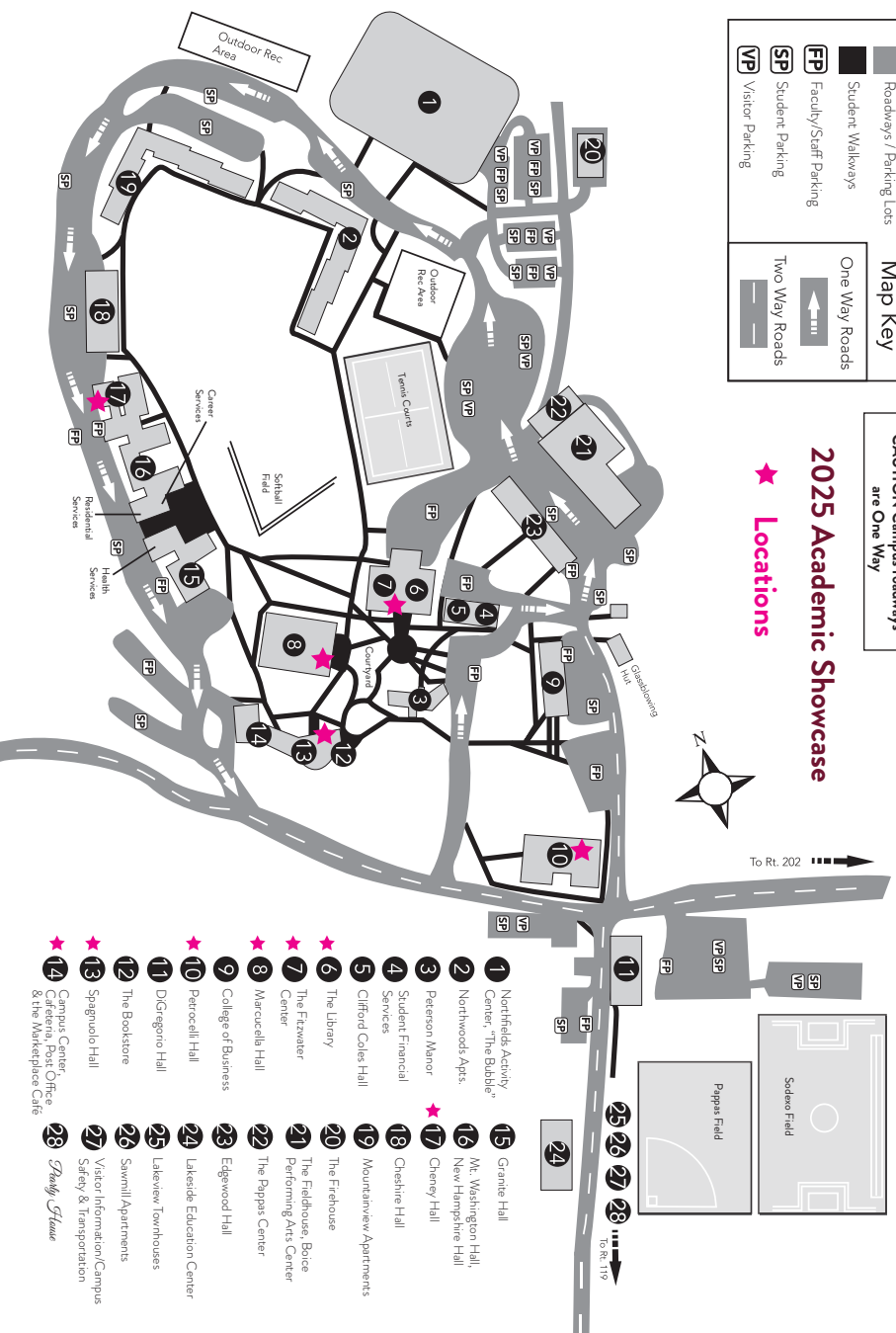

- ★ 1 Northfield Activity Center, "The Bubble"
- ★ 2 Northwest Apts.
- ★ 3 Peterson Manor
- ★ 4 Student Financial Services
- ★ 5 Clifford Cole Hall
- ★ 6 The Library
- ★ 7 The Fitzwater Center
- ★ 8 Mercucella Hall
- ★ 9 College of Business
- ★ 10 Percocelli Hall
- ★ 11 DiGregorio Hall
- ★ 12 The Bookstore
- ★ 13 Spagnuolo Hall
- ★ 14 Campus Center, Cafeteria, Post Office, & the Marketplace Cafe
- ★ 15 Granite Hall
- ★ 16 Mt. Washington Hall, New Hampshire Hall
- ★ 17 Cherry Hall
- ★ 18 Cheshire Hall
- ★ 19 Mountainview Apartments
- ★ 20 The Freshhouse
- ★ 21 The Fiddhouse, Boice Performing Arts Center
- ★ 22 The Pappas Center
- ★ 23 Edgewood Hall
- ★ 24 Lakeside Education Center
- ★ 25 Lakeview Townhouses
- ★ 26 Sawmill Apartments
- ★ 27 Visitor Information/Campus Safety & Transportation
- ★ 28 *Shady Grove*