



# Class of 2028 Orientation Schedule

## WELCOME HOME!

*franklinpierce.edu/orientation*

### Move-In Day: Saturday, August 24

TIME	ACTIVITY	LOCATION
9 a.m. - 12 p.m.	<b>New Residential and Transfer Student Move-in</b>	
	New Residential Student Check-In	Four Corners (Intersection of Mountain Road/ University Drive, adjacent to DiGregorio Hall)
	Drive-through Residence Hall & Health Check-In	Granite Parking Lot
10:30 - 11:30 a.m.	Commuter Student Arrival <ul style="list-style-type: none"> <li>New Student Check-in at Four Corners</li> <li>Drive-through Health Services Check-in at Granite Parking Lot</li> </ul>	<ul style="list-style-type: none"> <li>Four Corners</li> <li>Granite Parking Lot (Intersection of Mountain Road/University Drive, adjacent to DiGregorio Hall)</li> </ul>
9 a.m. - 1 p.m.	Resources Tables Available	
	Counseling Services, General Information & Information Technology Staff Assistance	First Year Courtyard
	Bookstore/Online Textbook Pre-Order Pickup	Rear of the Bookstore, Emily Flint Campus Center
	Post Office Key and Package Pickup	Post Office, Emily Flint Campus Center
	Student Employment Process	Pioneer Lounge, Emily Flint Campus Center
	Student Photo ID Pictures/Vehicle Registration	Pioneer Lounge, Emily Flint Campus Center
	Raven Card Deposits	Student Financial Services, Coles Hall
11:30 a.m.	<b>President's Welcome from Dr. Peter Eden</b> <i>Hear from President Peter Eden as he welcomes the Class of 2028 and their families to Raven Nation!</i>	Orientation Tent, Cheshire Field
12 - 1 p.m.	Lunch on Cheshire Field	Orientation Tent, Cheshire Field
1:15 - 1:45 p.m.	Parent & Family Session <i>Derek Scalia, Director of the Student Success Center, will offer insight into the first six weeks of college.</i>	Orientation Tent, Cheshire Field

## Move-In Day: Saturday, August 24

TIME	ACTIVITY	LOCATION
1:15 - 1:45 p.m.	Student Session & Class of 2028 Group Photo <i>Join the Student Engagement and Raven Recreation Staff for a Class of 2028 photo, and information about upcoming programming and events.</i>	Peterson Manor Lawn
2 p.m.	Parent & Family Goodbyes <i>It's time to part ways for now, but remember, Fall Festival is right around the corner on September 28 - 29!</i>	Orientation Tent, Cheshire Field
2:15 - 3:30 p.m.	Meet Your Fellow Ravens & Peer Group Meetings <i>During this time, we will cover introductions, the Role of the Peer Leader for Orientation and FYI Classes, and provide an overview of how to use the Raven Nation App. You'll also learn more about the Orientation Schedule, Frequently Asked Questions, Raven Nation terms and 'How to Raven'!</i>	Orientation Tent, Cheshire Field
3:30 - 4:15 p.m.	International Student Session <i>Coordinator of International Students, Hope Driscoll, will meet with International Students for a mandatory F-1 immigration orientation.</i>	Student Success Center, 4th Floor of Library
3:30 - 4:15 p.m.	Commuter Student Session <i>Commuter students will join Director of Student Engagement and Raven Recreation, Doug Carty, for an overview of commuter student life at Franklin Pierce University.</i>	Pioneer Lounge, Emily Flint Campus Center
5 - 6:30 p.m.	Dinner	Marketplace Café, Emily Flint Campus Center
7 - 8 p.m.	Residential Student Floor Meetings <i>Meet your Community Assistant, Residence Directors and new neighbors. Ask questions, be informed of best practices when sharing housing.</i>	Residence Halls
8 - 9:30 p.m.	Playfair <i>Get ready to meet your new best friends! Playfair is a professionally facilitated, high-energy performance where the students are the stars of the show!</i>	Melissa Bisaccia Softball Field
9:30 p.m.	Optional Activities <i>Stop by the North Fields Activity Center "The Bubble" until 11 p.m. or play Beach Volleyball under the lights, across from Mountain View Residence Halls.</i>	

## Orientation Begins: Sunday, August 25

TIME	ACTIVITY	LOCATION
7:15 - 10 a.m.	Breakfast	Marketplace Café, Emily Flint Campus Center
8 - 10 a.m.	Choose Your Adventure <ul style="list-style-type: none"> <li>• Take the Shuttle to Walmart Shuttle: Pick up in Granite Courtyard</li> <li>• United Christian Church Shuttle: Jaffrey, NH 10 a.m. service (Shuttle will depart from the Granite Courtyard at 9:40 a.m.)</li> <li>• Enjoy the Boathouse at Lakeside Park</li> <li>• Take a guided short trail hike: Venture into the wild side of campus for a short trail loop. Please wear appropriate closed-toed shoes and bring a bottle of water. Meet at Four Corners (Intersection of Mountain Road/University Drive, adjacent to DiGregorio Hall)</li> <li>• Play Lawn Games (Corn Hole, Kan Jam, Spikeball and Giant Jenga) on the Academic Triangle</li> <li>• North Fields Activity Center (The Bubble) Opens at 9 a.m. Come down, learn our policies, work out or play.</li> </ul>	
11:30 a.m. - 12:30 p.m.	Lunch	Marketplace Café, Emily Flint Campus Center

## Orientation Begins: Sunday, August 25

TIME	ACTIVITY	LOCATION
12:40 p.m.	Keynote Speaker, John Massaro '18 <i>John Massaro, former FPU Lacrosse Captain, Peer Leader and Club President, speaks about his experiences as a Raven.</i>	Orientation Tent, Cheshire Field
1 p.m.	Get a Life! Community Engagement <i>What every student needs to know about college success and community engagement.</i>	Orientation Tent, Cheshire Field
2:15 p.m.	Housing, Conduct, Counseling & Wellness <i>Director of Residential Life and Community Standards, Heather Ventresco, and Director of Counseling and Joint Health Services, Nicole Newell, share important policies, information and guidance for campus life.</i>	Orientation Tent, Cheshire Field
3 p.m.	Campus Safety, Rindge Police, and Fire Departments <i>Campus Safety, Rindge Police and Rindge Fire Department discuss important local ordinances and safety on campus.</i>	Orientation Tent, Cheshire Field
3:30 - 5:30 p.m.	Raven's Carnival <i>Prior to kickoff, join your fellow Ravens at Sodexo Field. Inflatable Ninja Warrior Course, "Monstah" Cookie Truck ice cream sandwiches, photo booth, half-time events, and prizes!</i>	Sodexo Field
4 - 6 p.m.	Defending Three-Time National Champion Men's Soccer vs. Babson College <i>Join Raven Nation and show your Pierce Pride! The first 200 Ravens in attendance receive a Raven Nation t-shirt.</i>	Sodexo Field
5 - 7 p.m.	Dinner	Marketplace Café, Emily Flint Campus Center
7 - 8:30 p.m.	Zero Shades of Grey <i>Zero Shades of Gray applies the Collegiate Empowerment best practices of delivering a high-energy, interactive, engaging, and fun experience that is totally relevant and hits the biggest points of how to approach sexual assault for first year students.</i>	Orientation Tent, Cheshire Field
8:30 p.m.	Robert Channing <i>As seen on TV around the world, renowned hypnotist, mentalist, comedian and speed painter, Robert Channing brings his unique brand of wit, comedy and entertainment to Franklin Pierce!</i>	Orientation Tent, Cheshire Field

## Orientation Continues: Monday, August 26

TIME	ACTIVITY	LOCATION
10:15 - 10:45 a.m.	Academic Convocation <i>Faculty, staff and administration greet the incoming Class and kick off the new academic year.</i>	Orientation Tent, Cheshire Field
11 a.m.	First Year Inquiry (FYI) Meetings with Faculty and Peer Leaders <i>Meet your professor and first-year advisor to discuss the academic transitions to college.</i>	Orientation Tent, Cheshire Field
12 - 1 p.m.	Lunch	Marketplace Café, Emily Flint Campus Center
1 - 2 p.m.	Academic College Ice Cream Social <i>Meet with your fellow students in your major and share some ice cream.</i> <ul style="list-style-type: none"> <li>o College of Business - Monadnock Hall</li> <li>o College of Liberal Arts &amp; Social Sciences - Petrocelli Hall</li> <li>o College of Health &amp; Natural Sciences - Marcucella Hall</li> <li>o Undeclared/Still Exploring - Student Success Center, 4th Floor of the Library</li> </ul>	
3 - 4:45 p.m.	20th Annual Cardboard Boat Regatta <i>A tradition since 2004, compete with your peer group to craft a cardboard boat only using cardboard, duct tape and plastic wrap. Prizes awarded for best design, best team effort, and fastest time.</i>	Peterson Manor Lawn

## Orientation Continues: Monday, August 26

TIME	ACTIVITY	LOCATION
5 - 6:30 p.m.	Dinner	Marketplace Café, Emily Flint Campus Center
8:30 - 10 p.m.	Movie Night: Student Engagement hosts a showing of "The Fall Guy", featuring Ryan Gosling and Emily Blunt	Peterson Manor Lawn (Rain Location - Spagnuolo Hall)

## Kick off the Fall Semester: Tuesday, August 27

TIME	ACTIVITY	LOCATION
8 a.m.	Classes Begin for the 2024 - 2025 Academic Year	
8 - 9 a.m.	Flow in to the Fall Semester <i>Start your first day of classes with Michelle Davis, yoga teacher and Reiki II practitioner. Michelle draws inspiration from the natural world and its power to heal, transform and connect people. Mats and towels provided. Sessions continue Thursday, August 28, Tuesday, September 3, and Thursday, September 5.</i>	Library Café Patio (Rain Location - Spagnuolo Hall Atrium)

## WELCOME BACK EVENTS

### FRIDAY, AUGUST 30

4 - 6 p.m.

#### Engagement/Club Fair, Freshman Courtyard

This is your chance to join or start a club, learn more about student programs, and meet the professional staff who advise the process. We have nearly 40 student organizations across campus - get involved!

### SATURDAY, AUGUST 31

2 - 5 p.m.

#### "Rec Fest" Streetball Tourney, Outdoor Basketball Courts across from Northwoods Apartments

Find some friends, make a team, and compete 3 vs. 3 to be the semester's first intramural champions. Don't play? Join us as spectator, listen to the live DJ, and get some swag from the airbrush artist. Be sure to sign up at the Engagement/Club Fair!

### SUNDAY, SEPTEMBER 1

11 a.m. - 1 p.m.

#### Oozeball Mud Volleyball Tournament, behind Lakeside Education Center Boathouse

Rototilled to perfection, the mud volleyball awaits your 4v4 team for a best of 3, single elimination tournament. Intramural Champion T-shirts for the winners. Everyone is encouraged to rinse off in the lake after!

### SATURDAY, SEPTEMBER 7

11:30 a.m. - 4 p.m.

#### 52nd Annual Grand Monadnock Climb

Each year, the Franklin Pierce Community comes together to hike our favorite mountain, Mount Monadnock. Transportation leaves from Peterson Manor Lawn at 11 a.m.

Students should bring close-toed shoes, a day pack, an extra clothing layer (it can get chilly at the top) and water/snacks. Members of faculty, staff, and administration will be present along the trip. The goal for the day is not necessarily reaching the summit, so climb as high as you'd like before heading back down to the shuttles. A commemorative 32oz Nalgene bottle provided for all participants!

# Map Key

	Roadways / Parking Lots		Student Walkways
	Parking A		One Way Roads
	Parking B		Two Way Roads

## Opening Day Temporary One Way

\*CAUTION Campus roadways are One Way



Directions to (5) Student Financial Services and back to Four Corners.

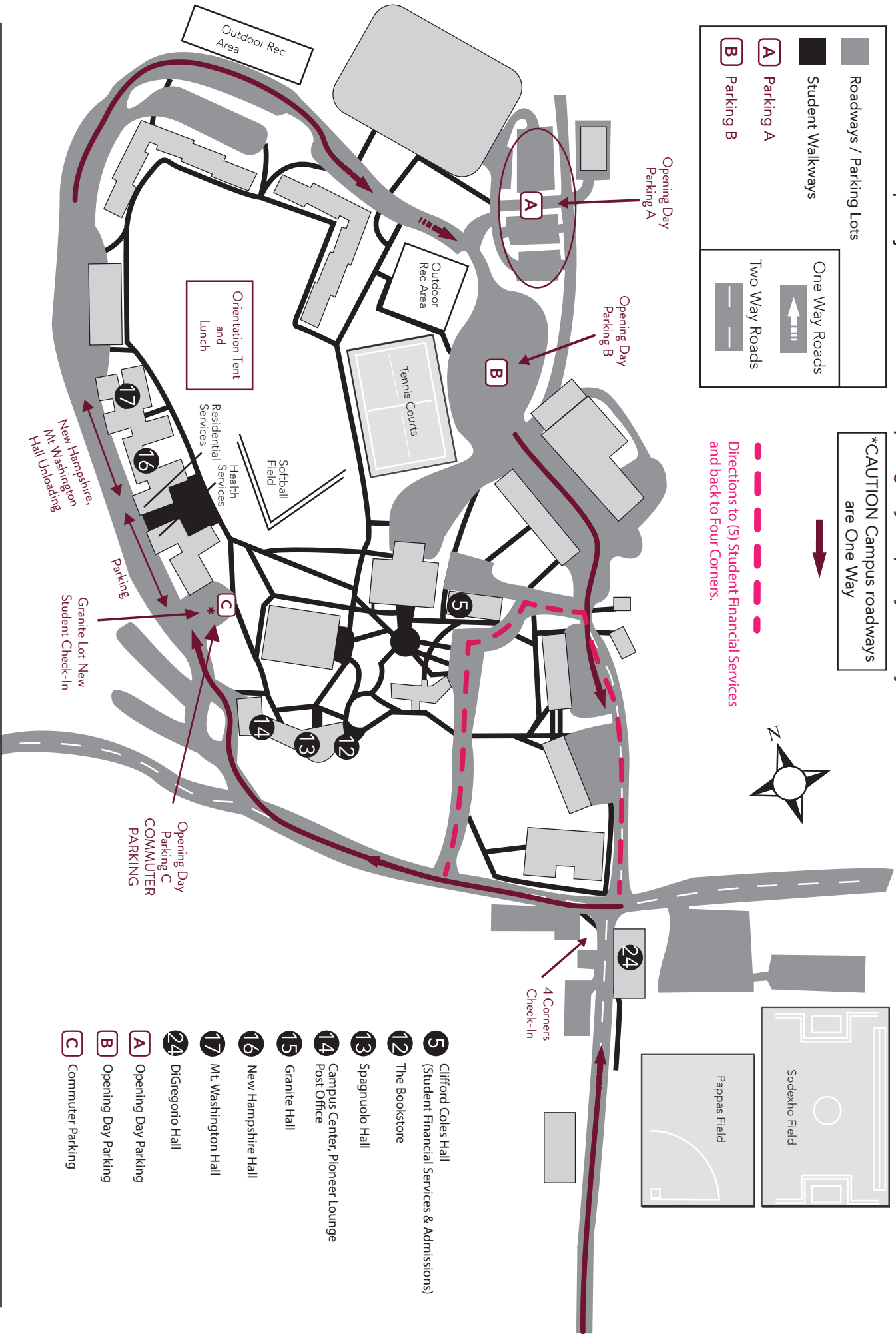

- 5 Clifford Coles Hall (Student Financial Services & Admissions)
- 12 The Bookstore
- 13 Spagnuolo Hall
- 14 Campus Center, Pioneer Lounge
- 15 Granite Hall
- 16 New Hampshire Hall
- 17 Mt. Washington Hall
- 24 DiGregorio Hall
- A Opening Day Parking
- B Opening Day Parking
- C Commuter Parking